



EAVL-T Series

EVOTEK level switches with thermo switch

Product Description

- Can be dismantled without removing the tank cap
- Direct mounting on tank lid
- Level and temperature control in the tank
- Suitable with many different fluids
- With any length up to 1000mm possible

Technical Specifications

Application	Electromagnetic level switches
Port Sizes:	Fastening by means of flange or screw connection
Material	
Flange/Threaded body:	Aluminium
Seals:	NBR or FPM or EPDM
Tube:	Stainless Steel
Float:	Stainless Steel
Temperature range:	-25°C to 110°C
Instrument plug:	DIN43650A
Degree of protection:	IP65
Switching current:	Level: max. 1.3 A Temperature: 2 A
Switching voltage:	Level: max. 220 V AC / 50 V DC Temperature: max. 220 V AC / 50 V DC
Switching power:	80 W
Temperature switching point:	60/70/80° C
Temperature accuracy:	± 10%
Contact functions:	Normally closed or normally open

EAVL-T Level switches with thermo switch

EAVL-T-G1

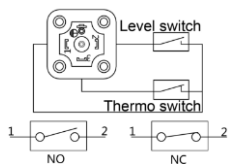
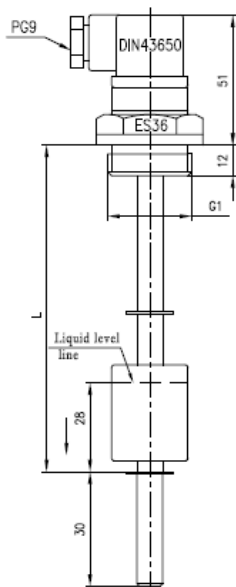

EAVL-T-F42

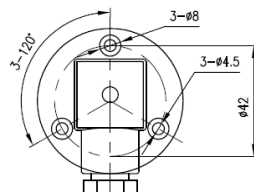
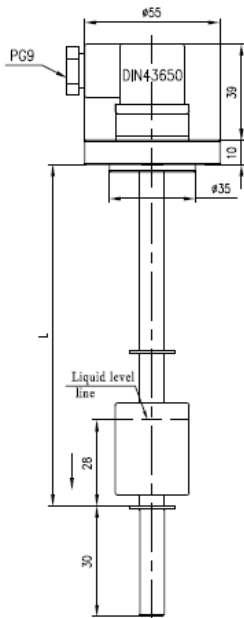

EAVL-T-M20

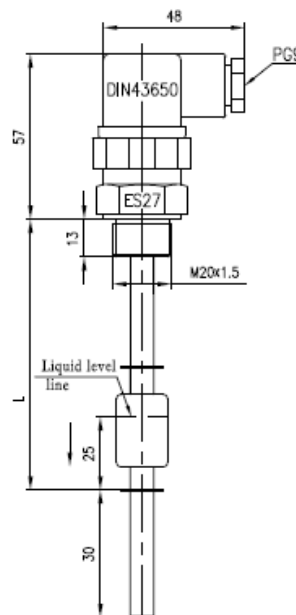

Order Codes

Series	-	A	-	B	C	D	E	F
EAVL-T	-	G1	-	500	B	NO	T60	NO

A Size Spare cartridge

G1	G 1" thread connection
F42	3 holes flange
M20	M20 thread connection

B Length(L)

150
200
250
300
400
500
600
800
1000

C Seal

B	NBR
V	FPM
E	EPDM

D Level switch Contact function

NO	Normally opened in presence of fluid
NC	Normally closed in presence of fluid

E Temperature switching point

T60	60°C
T70	70°C
T80	80°C

F Thermo switch Contact function

NO	Normally Open at set temperature
NC	Normally Closed at set temperature