



EAVT-LS Series

EVOTEK Level Sensor with thermo switch

Product Description

- Monitor the fluid level via an electrical signal. This switch signal can be used for a warning or to control the level.
- Better visual fluid level monitoring possible with yellow float
- Three nominal temperatures possible: 60 °C, 70 °C and 80 °C.
- to be mounted directly on to the operating fluid tank
- application in Machine tools, system engineering, tanks for hydraulic, lubricating and cutting oils, and gearboxes.

Technical Specifications

Application	Level Sensor with thermo switch
Port Sizes:	Mounted using two banjo bolts
Mounting position:	Vertically on the tank wall (connection plug at bottom of the tank)
Notes:	The upper viscosity limit is 2,000 mm ² /s.
Material	
Housing frame:	Aluminium
Seals:	NBR or FPM
Lens:	Polyamide
Connectors:	Polyamide
Temperature range:	-20°C to 80°C
Instrument plug:	DIN43650A
Degree of protection:	IP65
Switching current:	Level Sensor: 0.5A Thermo switch: 2A
Switching voltage:	Level Sensor: 12 - 50 V AC/DC Thermo switch: 250 VAC
Screw tightening torque:	8 ~ 10 Nm
Nominal pressure:	max. 0.5 bar
Operating fluids:	Mineral oil to DIN 51524 Part 1 and 2, water-oil emulsions and synthetic fluids, such as hydraulic fluids based on phosphate ester. (other fluids on request)

EAVT-LS Level Sensor with thermo switch

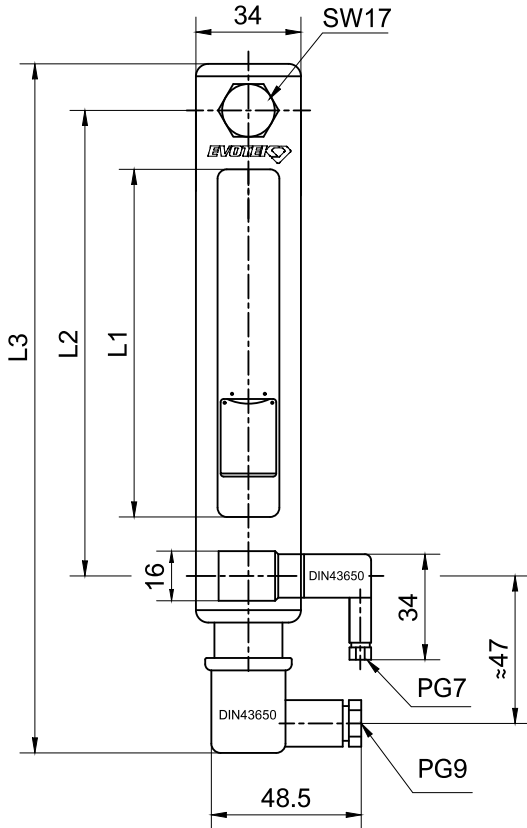

Level Sensor Connection

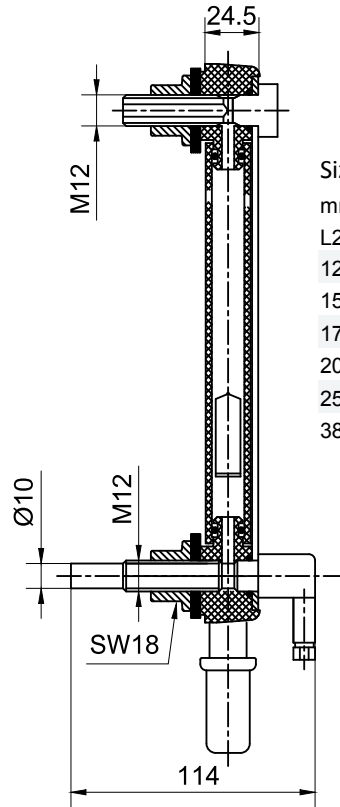

Thermo Switch Connection

Size			
mm	L2	L1	L3
127	88	199	
150	111	222	
176	137	248	
200	161	272	
254	2x90	326	
381	3x100	453	



Connector: DIN43650
Wiring: 1-2 (NO&NC)
Voltage: 12 - 50 V AC/DC
Current: 0.5A

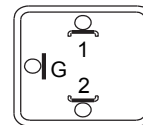

Connector: DIN43650
Wiring: 1-2 (NO&NC)
Voltage: 250 V AC
Current: 2A

Order Codes

Series	A	B	C	D	E	F	G
EAVT-LS	127	B	M12	Z	NO	T60	NO
A Length (L2)				D Fastening bolts and nuts material			
127				Z			
150				S			
176							
200				E Level switch Contact function			
254				NO			
381				NC			
				F Temperature switching point			
B Seal				T60			
B				T70			
V				T80			
				G Thermo switch Contact function			
C Installation conditions				NO			
M12				NC			