

# EVCF-NV2-08

## THROTTLE VALVE

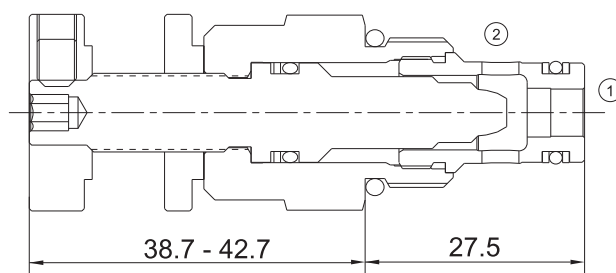

### Technical Specifications

Operating Pressure :	250Bar
Flow :	30L/min
Maximum internal leakage :	3drops/min at 250bar
Operating temperature :	-30°C to+ 120°C (- 22°F to+ 250°F)
Cavity :	VC08-2
Fluids:	Mineral based or synthetic hydraulic fluid with lubricating properties
Fluid viscosity range :	7.4 to 420cSt.

### Features

- Hardened seat for long life
- Compact size
- Industry common cavity
- Desired settings may be locked down.
- Positive shut- off

### Operation

The valve varies flow restriction by adjusting needle in or out and will shut off when fully closed. These Valves will meter flow in either direction.

### Symbol

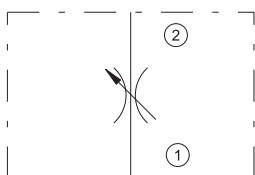

Order Codes

Base Model			Adjustment Option	Seals	
Example	EVC	F	NV2-08	Table 1	Table 2
	EVC	F	NV2-08	K	B

Table 1	
Code	Adjustment Option
Blank	Screw adjustment
K	Knob adjustment

Table 2	
Code	Seals
B	NBR
V	FKM

Performance Curves

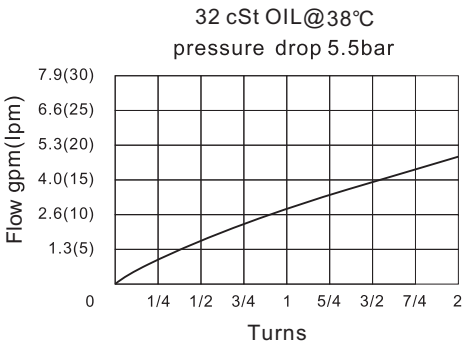

Installation Dimensions

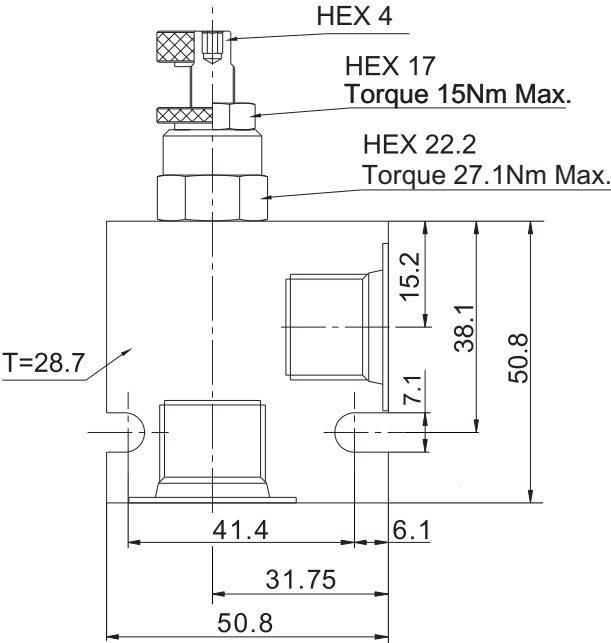

Technical specification subject to change without prior notice. Other specification on request. 2025